

IB 7/40 CLASSIC

Thanks to airflow optimisations, our Ice Blaster IB 7/40 impresses with excellent results during dry ice cleaning, even when working with low air pressures. Compact device.



Order no. 1.574-001.0

- Compact and agile
- Oil and water separator
- For in-house compressed air networks

Technical data

EAN code		4039784294028
Connection load	kW	0.6
Compressed air connection		Claw coupling (DIN 3238)
Casing / frame		Stainless steel (1.4301)
Air pressure	bar / MPa	2 - 10 / 0.2 - 1
Air quality		Dry & oil-free
Air flow	m³/min	0.5 - 3.5
Sound pressure level	dB(A)	99
Dry ice capacity	kg	15
Dry ice pellets (diameter)	mm	3
Dry ice consumption	kg/h	15 - 50
Number of current phases	Ph	1
Frequency	Hz	50 - 60
Voltage	V	220 - 240
Weight without accessories	kg	93
Weight (with accessories)	kg	75
Dimensions (L × W × H)	mm	768 × 510 × 1096

Users must receive training on this device.

Equipment

Grease for nozzle threads		■
Flat jet nozzle		■
Open-end wrench (for changing nozzles)	piece(s)	2
Spray hose with electrical control cable and quick coupling		■
Jet gun (ergonomic and safe)		■
Electronic control system		■
Oil and water separator		■
Tool bag		■

■ included in the scope of supply.



Clear display

- Easy to read off the values set; ease of operation thanks to large buttons and electronic control system.



Automatic residual ice discharge

- The ability to empty the residual ice tank at the touch of a button prevents the device from icing up once work is complete.



Integrated oil and water separator

- No icing up of the device.

ACCESSORIES FOR IB 7/40 CLASSIC

1.574-001.0

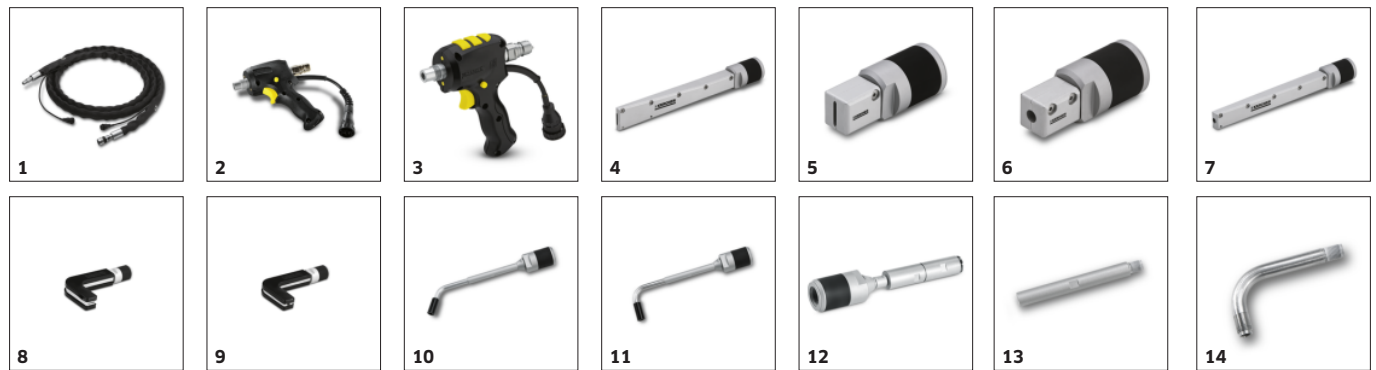

	Order no.	Description	
MIDDLE CLASS			
Blast gun and blast hose			
Spray hose, 1/2"	1 4.013-042.0	5 m spray hose with electric control cable and quick-action couplings, non-marking outer layer, silicone-free (1/2" diameter).	■
Jet gun, XS, classic	2 4.775-794.0	Ergonomic & lightweight blasting gun with safety device against accidental use. Because of its compact design the blasting gun is very lightweight and handy.	■
Jet gun, XS, Adv	3 4.775-785.0	Ergonomic & lightweight blasting gun with safety device against accidental use. Because of its compact design the blasting gun is very lightweight and handy. The advanced blasting gun has an integrated remote control to adjust the blasting pressure and the dry ice output directly on the blasting gun. Furthermore there is a button to choose between "air & ice" or "only air".	□
Low pressure - blasting nozzles			
Flat jet nozzle, XS, long	4 4.574-038.0	Highest efficiency and a low noise level are the result of our optimized nozzle design. Great cleaning results and high area performance.	■
Flat jet nozzle, XS, short	5 4.574-040.0	Highest efficiency and a low noise level are the result of our optimized nozzle design. Very short nozzle to blast in narrow areas.	□
Round spray nozzle, XS, short	6 4.574-039.0	Optimised nozzle geometry for maximum efficiency and minimum noise. Short, compact nozzle. Especially suited for use in small spaces.	□
Round spray nozzle, XS, long	7 4.574-037.0	Optimised nozzle geometry for maximum efficiency and minimum noise. High pressure for use against stubborn dirt.	□
Angled nozzle, XS, flat	8 4.574-042.0	Angled nozzle to direct the jet through 90°. Perfect for cleaning injection moulds.	□
Angled nozzle, XS, round	9 4.574-041.0		□
Mini angled nozzle, 60°, XS	10 4.574-044.0	Mini angled nozzle for use in small spaces. Directs the jet through 60° laterally. Protrudes 57 mm laterally, length: 260 mm. The set consists of four parts: 1 × union nut 1 × extension piece, 100 mm (5.321-971.0) 1 × elbow attachment, 60° (5.321-972.0) 1 × nozzle tip (5.321-977.0) Supports as many extension pieces as needed. The elbow attachment and nozzle piece can be ordered separately.	□
Mini angled nozzle, 90°, XS	11 4.574-043.0	Mini angled nozzle for use in small spaces. Directs the jet through 90° laterally. Protrudes 63 mm laterally, length: 240 mm. The set consists of four parts: 1 × union nut 1 × extension piece, 100 mm (5.321-971.0) 1 × elbow attachment, 90° (5.321-973.0) 1 × nozzle tip (5.321-977.0) Supports as many extension pieces as needed. The elbow attachment and nozzle piece can be ordered separately.	□
Cavity nozzle, XS	12 4.574-045.0	Diameter: 22 mm. Any number of extension pieces can be attached.	□
Extension, 100 mm	13 5.321-971.0	100 mm Extension for Mini angled nozzles (60°, 90°, 135°)	□
Angle, 90°	14 5.321-973.0	90° angle for all Mini angled nozzles.	□

■ Included in the scope of supply. □ Available accessories.

ACCESSORIES FOR IB 7/40 CLASSIC

1.574-001.0



		Order no.	Description	
MIDDLE CLASS				
Low pressure - blasting nozzles				
Angle, 60°	15	5.321-972.0	60° angle for all Mini angled nozzles.	<input type="checkbox"/>
Replacement nozzle	16	5.321-977.0	Nozzle piece for all Mini angled nozzles.	<input type="checkbox"/>
Straight adapter for angled nozzle	17	5.321-992.0	Can be attached to all miniature angled nozzles. Converts a miniature angled nozzle to a straight nozzle.	<input type="checkbox"/>
Nozzle accessories				
Nozzle extension, XS, 300 mm	18	4.574-046.0	300 mm nozzle extension	<input type="checkbox"/>
Handle, IB 7/40	19	4.321-248.0	Handle to mount on the nozzle extension. For easy two handed working.	<input type="checkbox"/>
Nozzle light, IB 7/40	20	2.815-011.0	Illuminator can be screwed onto the jet gun to light up the work area.	<input type="checkbox"/>
DRY ICE CLEANING				
Nozzle accessories				
Open-end wrench (size 27 mm)	21	7.815-009.0	Open-end wrench for mounting nozzles (2 pcs required)	■
Grease for nozzle thread, silicone-free	22	6.288-088.0	The threads of the blasting nozzles must be regularly treated with this silicone-free grease.	■
Scrambler	23	4.574-026.0	The innovative scrambler, patented by Kärcher, is attached between the spray gun and spray nozzle and breaks the 3 mm dry ice pellets into a fine spray of tiny particles. This makes cleaning delicate surfaces possible. The intensity of the scrambler's effect on the pellets can be set to three different levels.	<input type="checkbox"/>
Double scrambler	24	4.574-052.0	Additional scrambler for producing even finer jet particles alongside the normal scrambler attachment. The double scrambler can be attached to the normal scrambler, saving space.	<input type="checkbox"/>
Blasting hose, compressed air hose				
Hose trolley	25	4.574-057.0	Hose reel including all adaptors. Handy device assists you in dry ice spraying, and is suitable for 80 m compressed air hoses with a 1" diameter.	<input type="checkbox"/>
Compressed air hose, 1", 5 m	26	6.574-279.0	Lightweight, stable compressed air hose (1", 5 m) for use with the Ice Blaster. Ideal for connecting the hose reel to the compressor.	<input type="checkbox"/>
Compressed air hose, 1", 20 m	27	6.574-280.0	Lightweight, stable compressed air hose (1", 20 m) for use with the Ice Blaster. The hose can be neatly wound back onto the Kärcher hose reel after use.	<input type="checkbox"/>
Compressed air hose, 1", 60 m	28	6.574-281.0	Lightweight, stable compressed air hose (1", 60 m) for use with the Ice Blaster. The hose can be neatly wound back onto the Kärcher hose reel after use.	<input type="checkbox"/>

■ Included in the scope of supply. □ Available accessories.

ACCESSORIES FOR IB 7/40 CLASSIC

1.574-001.0

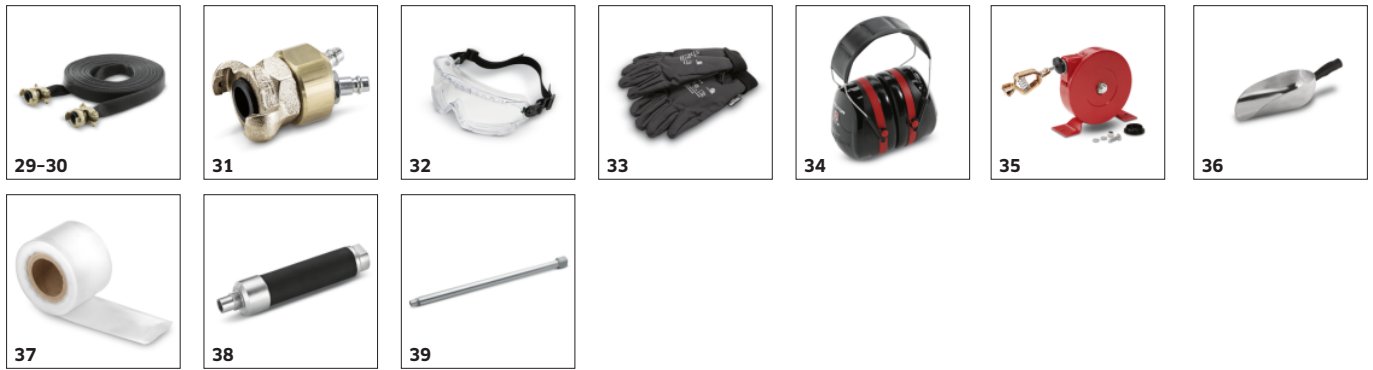

		Order no.	Description	
DRY ICE CLEANING				
Blasting hose, compressed air hose				
Compressed air hose, 10 m	29	6.390-284.0	Folding compressed air hose with inner diameter 3/4" and 10 m length.	<input type="checkbox"/>
Compressed air hose, 20 m	30	6.390-285.0	20 m long, folding compressed air hose with inner diameter 3/4".	<input type="checkbox"/>
Y adapter, air supply	31	2.641-880.0	Y-adapter for connecting the air hose to two 1/4" quick coupling connections.	<input type="checkbox"/>
Protective equipment				
Safety glasses	32	6.321-208.0	Safety goggles.	<input type="checkbox"/>
Protective gloves	33	6.321-210.0	Cold protection glove, size 10 with slip-resistant profile (Category 3 according to EN 511, Level 12X EN 388, Level 2121).	<input type="checkbox"/>
Hearing protection	34	6.321-207.0	Effective hearing protection with an average insulation rating of 35 dB(A) according to SNR (Single Number Rating).	<input type="checkbox"/>
Mounting kits and other accessories				
Earth wire rewinder	35	2.641-741.0	Automatic electrostatic discharge wire with approximately 6 m wire and powerful clamp. The earth wire effectively prevents electrostatic charge of the cleaning object during ice blasting and with that sparks between object and nozzle. The earthing of the cleaning object is done over the grounding conductor of the Ice Blaster.	<input type="checkbox"/>
Shovel	36	4.321-198.0	Used for filling the machine with dry ice pellets	<input type="checkbox"/>
Protective foil for IB spray hose, 100 m	37	6.667-214.0	100m-role of tube foil. To protect the blasting hose against dirt as well as against damage.	<input type="checkbox"/>
SUPER CLASS				
Nozzle accessories				
Nozzle extension, XXL, 170 mm	38	4.574-027.0	170 mm nozzle extension	<input type="checkbox"/>
Nozzle extension, XXL, 500 mm	39	4.574-060.0	500 mm nozzle extension.	<input type="checkbox"/>
PROTECTIVE EYEWEAR				
UVEX Safety goggles, clear	40	6.025-482.0	Innovative safety goggles in the athletic Kärcher design. With clear lens - scratch-resistant and non-fogging - for optimal transparency when working and playing. Includes microfibre bag.	<input type="checkbox"/>
HEARING AND HEAD PROTECTION				
Reusable ear plugs	41	6.025-511.0	Reusable ear plugs with a very good insulating effect of up to 31 dB(A) (SNR value) that are also extremely comfortable to wear. Easy to clean thanks to the smooth surface. Practical hygiene box included.	<input type="checkbox"/>

■ Included in the scope of supply. □ Available accessories.